



1500i & 2000i

What to specify...

1. Model

2. Voltage

3. Volume or Vacuum

4. Pre-filter

5. Main filter

6. Connection Kit

7. Interfacing Kit

	1500i		2000i	
1				
2				
3				
Voltage	230V ±10%	120V ±10%	400V 3ph + N	220V 3ph
Part number (Volume Control)	0LX1510D	0LX1511D	0LX2010D	0LX2011D
Part number (Vacuum Control)	021820iD	021821iD	022120iD	022121iD
Wattage	1.5 kW	1.5 kW	3.0 kW	3.0 kW
Frequency	50Hz / 60 Hz	50Hz / 60 Hz	50Hz / 60 Hz	50Hz / 60 Hz
Cabinet height (inc castors)	1400 mm	1400 mm	1400 mm	1400 mm
Cabinet width (not inc hose)	725 mm	725 mm	725 mm	725 mm
Cabinet depth (not inc hose)	726 mm	726 mm	726 mm	726 mm
Cabinet weight (inc filters)	150 Kg	150 Kg	150 Kg	150 Kg
RRP	\$9,135.00	\$9,135.00	\$9,783.00	\$9,783.00

4 **Labyrinth Pre-filter** **FREE**



Options:	Code:	Price:
F6 (std)	111037	\$302.00
F8/F9 Composite	111099	\$369.00

5 **Main filter** **FREE**



Options:	Code:	Price:
HEPA/Chemical (std)	110615	\$1048.00
HEPA/Twin Chemical	110614	\$1048.00
HEPA/Chemical Cleanroom	110632	\$1048.00
Chemical	110610	\$1048.00
Castellated Chemical	110620	\$1048.00



6 **Connection Hose Kit (Optional)**

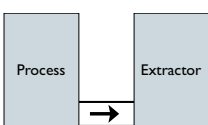

Connect to Lasers **PAGE36**
Connect to Pipework/Machinery **PAGE37**

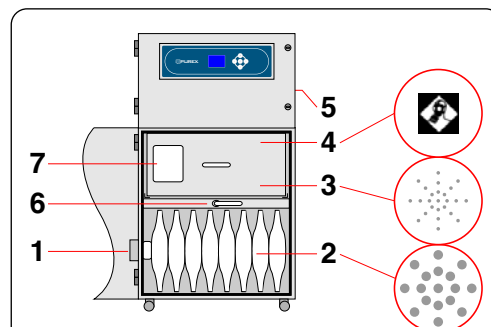

Legend:

- 1) Air inlet.
- 2) Pre-filter.
- 3) Main Filter (HEPA location). †
- 4) Main Filter (Carbon location). †
- 5) Clean air returned to workplace.
- 6) Filter locking handle.
- 7) Filter identification label.

All machines are mounted on four castors for increased mobility.

† Standard Filter Only

7 **Machine Interfacing Kit (Optional)**

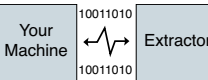

Start/Stop Control: Extraction unit starts/stops when a connected piece of equipment is switched ON/OFF.

Filter Blocked Warning: A signal is sent to a connected piece of equipment to trigger an alert or to shut it down.

Allows the Purex system to interface with a piece of equipment connected to it.

See **PAGE 40**

Digital Control System

A dedicated control, monitoring and display system unique to Purex fume extractors. All functions are fully automatic, all the user has to do is set the appropriate airflow on installation. The features of this system are designed to:

- Lower energy consumption by using variable speed motors and automatic flow control.
- Increase filter life by using the optimal extraction rate.
- Further protect people by constantly monitoring exhaust emissions.
- Interface with other equipment e.g. a laser.
- Maintain a constant extraction rate to prevent fume escape or damage to equipment.

System Features...

- Automatic electronic flow control - maintains a constant extraction rate even as the filter blocks
- Adjustable airflow
- Clear and informative graphic display
- Gas and Particle Sensors on the exhaust
- Low capital and running costs
- Quick change patented Labyrinth pre-filters deliver longer filter life
- Submicronic (HEPA) filtration removes 99.997% of particles down to 0.3 microns
- Activated carbon filtration removes harmful gas
- Simple to install and quiet in operation
- Easy to relocate and precision made from stainless steel

Supplied free with every machine purchase
1 x Main filter
1 x Labyrinth Pre-filter
1 x Power cable (no plug)

Accessories

Please see the accessories section at the back of this brochure.