



200i & 400i

What to specify...

1. Model

2. Voltage

3. Volume or Vacuum

4. Pre-filter

5. Main filter

6. Connection Kit

7. Interfacing Kit

	200i		400i	
1				
2				
3				
Voltage	230V ±10%	120V ±10%	230V ±10%	120V ±10%
Part number (Volume Control)	0LX2110D	0LX2121D	0LX4010D	0LX4013D
Part number (Vacuum Control)	080026iD	081026iD	080410iD	080411iD
Wattage	0.45 kW	0.45 kW	1.2 kW	1.1 kW
Frequency	50Hz / 60 Hz	50Hz / 60 Hz	50Hz / 60 Hz	50Hz / 60 Hz
Cabinet height (inc castors)	1070 mm	1070 mm	1070 mm	1070 mm
Cabinet width (not inc hose)	465 mm	465 mm	465 mm	465 mm
Cabinet depth (not inc hose)	513 mm	513 mm	513 mm	513 mm
Cabinet weight	60 Kg	60 Kg	60 Kg	60 Kg
RRP	\$3,915.00	\$3,915.00	\$4,653.00	\$4,653.00

4 **Labyrinth Pre-filter** **FREE**



Options: (Pack of 2):

Options:	Code:	Price:
F6 (std)	202268	\$262.00
F8/F9 Composite	202271	\$338.00

5 **Main filter** **FREE**



Options:

Options:	Code:	Price:
HEPA/Chemical (std)	113505	\$502.00
HEPA/Twin Chemical	113579	\$502.00
HEPA/Chemical Cleanroom	113512	\$502.00
Chemical	113508	\$502.00
HEPA/CSA	113662	\$502.00
Pleated Bag	113531	\$205.00

6 **Connection Hose Kit** **FREE**

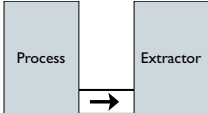

Connect to Lasers **PAGE35**
 Connect to Pipework/Machinery **PAGE37**
 Connect to Soldering Irons **PAGE39**

7 **Machine Interfacing Kit (Optional)**

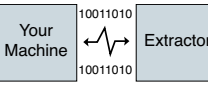

Start/Stop Control: Extraction unit starts/stops when a connected piece of equipment is switched ON/OFF.

Filter Blocked Warning: A signal is sent to a connected piece of equipment to trigger an alert or to shut it down.

Allows the Purex system to interface with a piece of equipment connected to it.

See **PAGE 40**

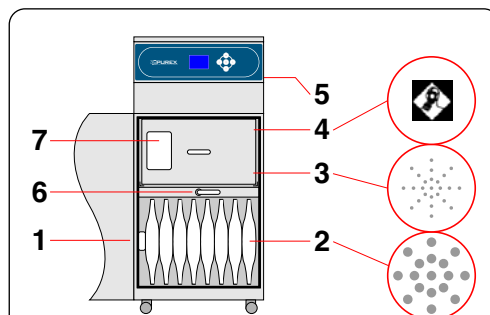

Legend:

- 1) Air inlet.
- 2) Pre-filter.
- 3) Main Filter (HEPA location). †
- 4) Main Filter (Carbon location). †
- 5) Clean air returned to workplace.
- 6) Filter locking handle.
- 7) Filter identification label.

All machines are mounted on four castors for increased mobility.

† Standard Filter Only

Digital Control System

A dedicated control, monitoring and display system unique to Purex fume extractors. All functions are fully automatic, all the user has to do is set the appropriate airflow on installation. The features of this system are designed to:

- Lower energy consumption by using variable speed motors and automatic flow control.
- Increase filter life by using the optimal extraction rate.
- Further protect people by constantly monitoring exhaust emissions.
- Interface with other equipment e.g. a laser.
- Maintain a constant extraction rate to prevent fume escape or damage to equipment.

System Features...

- Automatic electronic flow control - maintains a constant extraction rate even as the filter blocks
- Adjustable airflow
- Clear and informative graphic display
- Gas and Particle Sensors on the exhaust
- Low capital and running costs
- Quick change patented Labyrinth pre-filters deliver longer filter life
- Submicronic (HEPA) filtration removes 99.997% of particles down to 0.3 microns
- Activated carbon filtration removes harmful gas
- Simple to install and quiet in operation
- Easy to relocate and precision made from stainless steel

Supplied free with every machine purchase

- 1 x Main filter
- 2 x Labyrinth Pre-filters
- 1 x Connection Kit
- 1 x Power cable (see pg41)

Accessories

Please see the accessories section at the back of this brochure.